

* "NAME OF FIRM" SHALL BE THE PERSON OR PERSONS RESPONSIBLE FOR THE FIELD LOCATION OF MARKER.

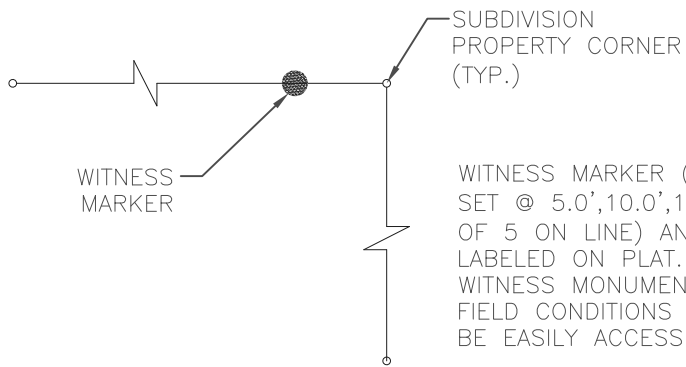

WITNESS MARKER (IF NEEDED) SHALL BE SET @ 5.0', 10.0', 15.0, OR 20.0' (INTERVALS OF 5 ON LINE) AND WILL BE SHOWN AND LABELED ON PLAT. THE LOCATION OF THE WITNESS MONUMENT SHALL BE BASED UPON FIELD CONDITIONS AND PLACED SO AS TO BE EASILY ACCESSIBLE.

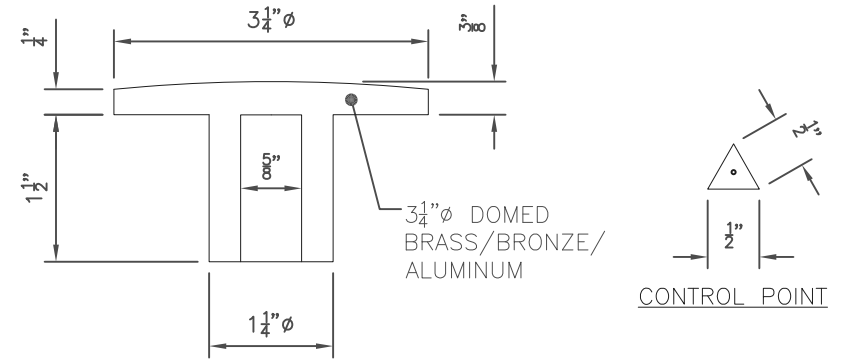

SECTION A-A

SUBDIVISION CORNER MONUMENT

NOTES:

1. THE STANDARD CORNER/WITNESS MARKER/DISK SHALL BE DRIVEN ON A #5 REINFORCEMENT BAR FOUR (4'-0") FOOT IN LENGTH. THE BAR ASSEMBLY SHALL BE DRIVEN INTO THE CENTER OF A SIX (6"Ø) INCH DIAMETER BY TWO-FOOT SIX (2'-6") INCH DEEP HOLE.
2. UNLESS OTHERWISE NOTED ON PLANS, CONCRETE SHALL BE CLASS A, 3500 psi READY MIX TYPE CONFORMING TO ASTM SPECIFICATION C94 AND COMPOSED OF PORTLAND CEMENT, SAND, AND WASHED COURSE LIMESTONE AGGREGATE.
3. THE ACTUAL CONTROL POINT SHALL BE STAMPED ON THE DISK.
4. SEE PLAT PLAN FOR MONUMENT LOCATIONS.



ENGINEERING DEPARTMENT

SUBDIVISION CORNER MONUMENT

DRAWN: MLC

DATE: 08.10.23

CHECKED: JDB

REVISED: _____

APPROVED: EWS

SCALE: NTS